



Plánek B1

Požární hydranty - lokalita Ptačina a Kolonie

Legenda:

-  požární nadzemní hydrant
-  požární podzemní hydrant
-  vodovodní řad

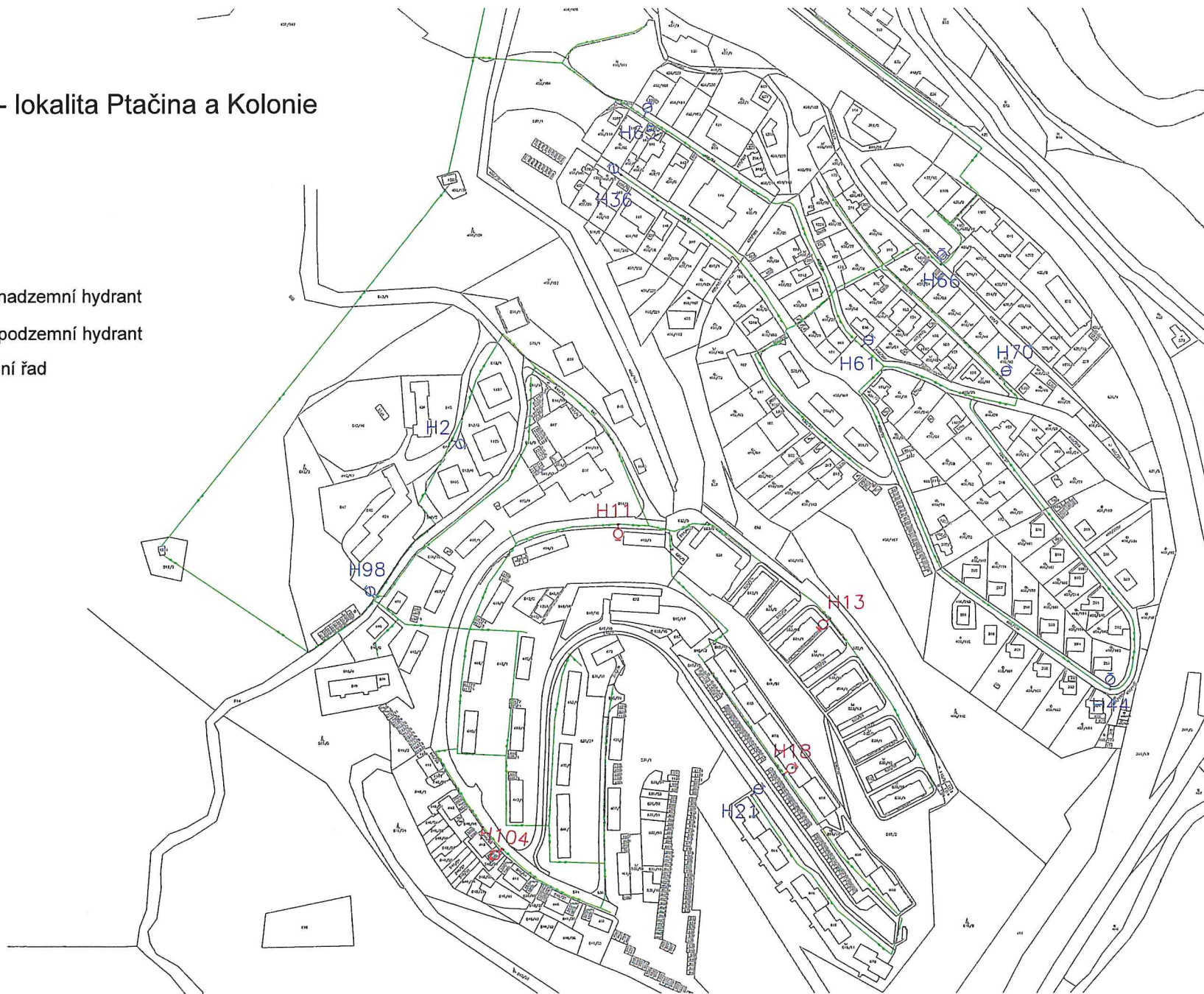

.Plánek B2

Požární hydranty - lokalita Horka



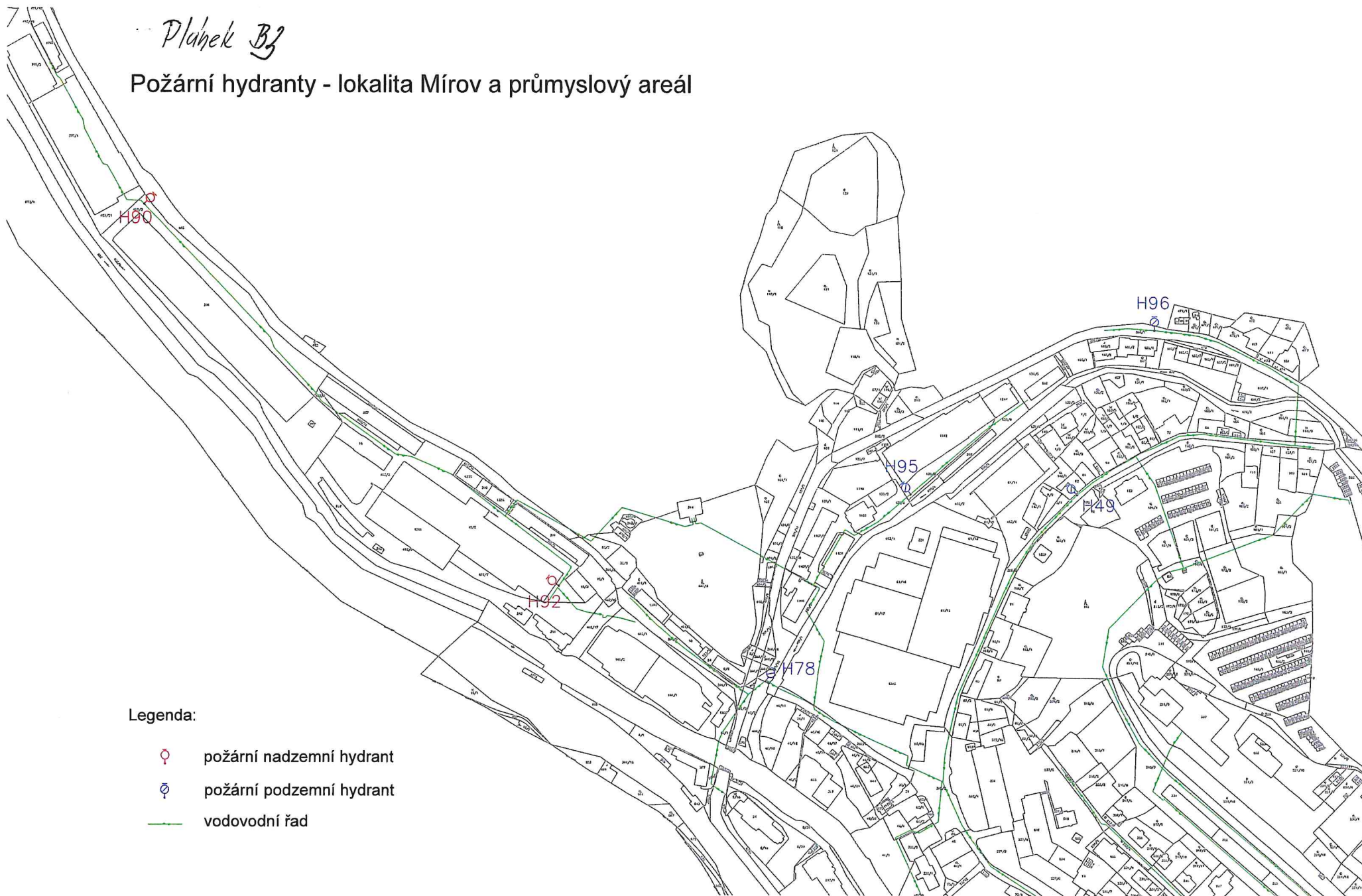

Plaňek B2

Požární hydranty - lokalita Mírov a průmyslový areál



Legenda:

-  požární nadzemní hydrant
-  požární podzemní hydrant
-  vodovodní řad